

# ELRO® Peristaltic Pumps Series XP

## The **eXtra** large **P**ump series

High performance at a lower speed

EL-WFD-XP/GB/07.04/MD

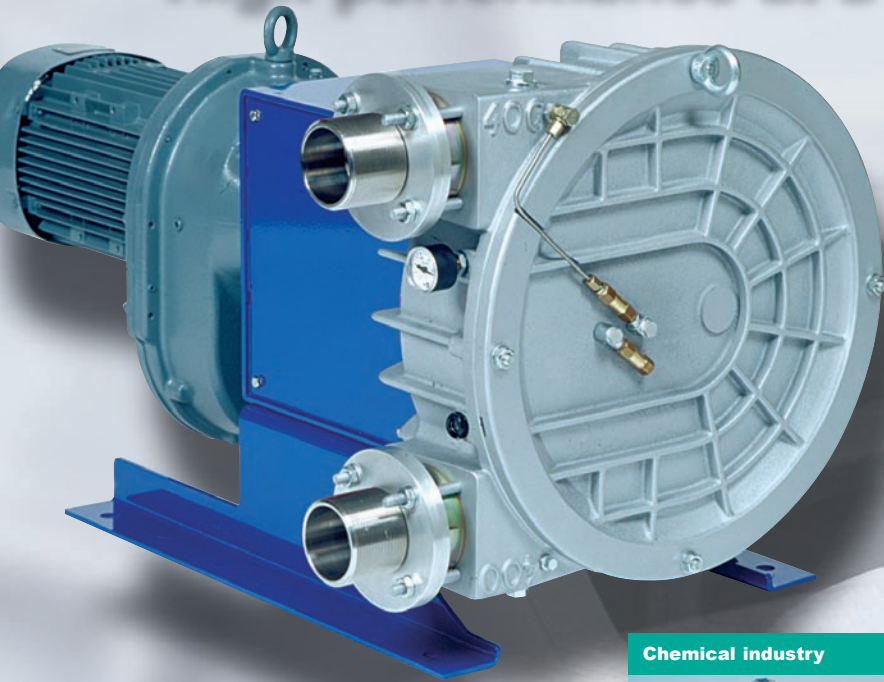

### Main areas of application:

- Chemical industry
- Ceramics and porcelain industry
- Construction industry
- Food and beverage industry
- Power plants
- Paint and lacquer industry
- Waste disposal industry

### Waste disposal industry



### Chemical industry



### Construction industry



## an alternative to conventional progressive cavity pumps

- ▶ Free of seals and dry run proof
- ▶ Very high pumping capacity
- ▶ Ideal for viscous media and large solids
- ▶ Only one wear part / low maintenance costs
- ▶ Long service life, easy to repair
- ▶ Space saving, compact design

**CRANE**

# ELRO® Peristaltic Pumps Series XP

## Technical Data

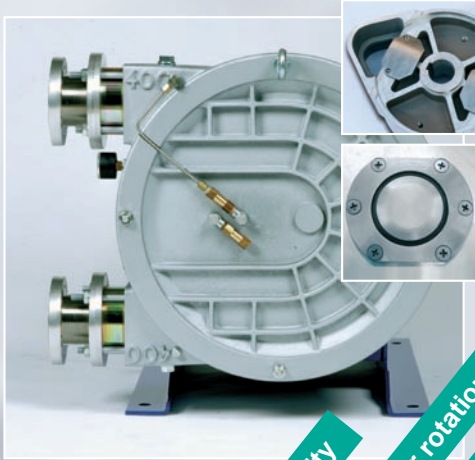

The newly developed peristaltic pumps of series XP are characterized by a high level of pumping performance at a lower speed. The large-scale hose cross section enables the delivery of media with high solids content.

- Compact style
- Dry run proof
- Integrated vacuum system
- Dry self-priming max. 9.5 m
- Unique vacuum system allows transfer of highly viscous products
- Discharge pressure max. 13 bar
- Ideal for fibrous and solid materials up to 40 mm
- Forward and backward flow possible
- Maintains full capacity throughout entire hose life
- Various hose and food connections available
- Flanged motor design

Type	Maximum capacity	Displacement per rotation	Max. discharge pressure	Internal diameter of hose	Maximum Speed	Drive power min.-max.	Weight without drive
	m <sup>3</sup> /h	l/U	bar	mm	U/min	kW	kg
XP 200	3,2	0,38	10	35	140	0,75 - 1,5	18
XP 400	9,6	2,67	13	63	60	1,5 - 5,5	53
XP 800	46,0	12,8	10	91	60	5,5 - 18,5	254

### Dimensions in mm

ELRO peristaltic pumps Series XP  
Type: XP400 with flanged helical gear motor assembled on a base frame

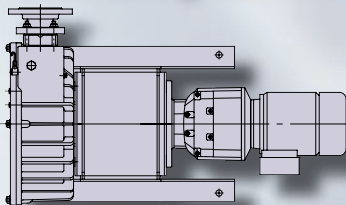
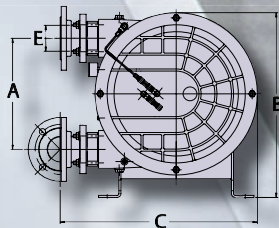
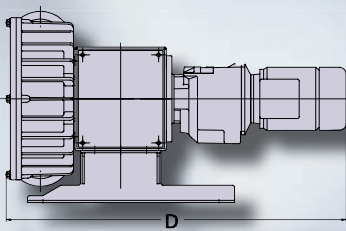

Typ	XP 200	XP 400	XP 800
E	(1 1/2")	(2 1/2")	(4")
A	140	322	692
B	303	535	1015
C	319	571	1023
D	891	985	1473

### Accessories



Reinforced plastic hose



Flange



Compensator



Conductivity sensors



Pulsation dampener

Please request our accessories catalogue for further information.

**CRANE**